



SHOX5

SALTCASTER X4 INFOSET

ALLSALT MARITIME HOME OF SHOXS AND KINETIX / ALLSALT.COM / (888) 637.4697



SALTCASTER X4 - DECK MOUNTED

Human Engineering Reference MIL-STD-1472G

Suspension Travel 4.4 in / 112 mm

Base Weight 65 lb / 29 kg

Weight with Options 93 lbs / 42 kg

Material CNC Aluminum / 316 SS

Options Fore/aft, swivel, height adjust

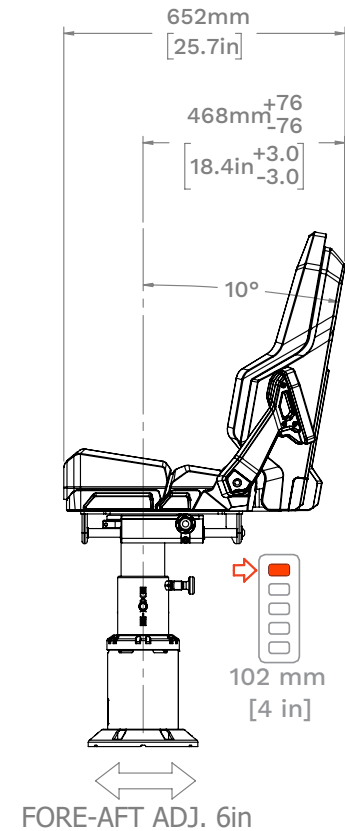
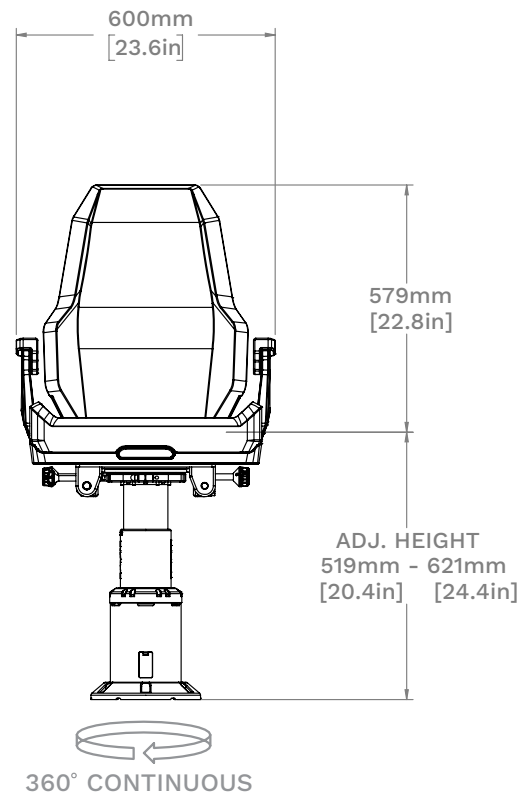
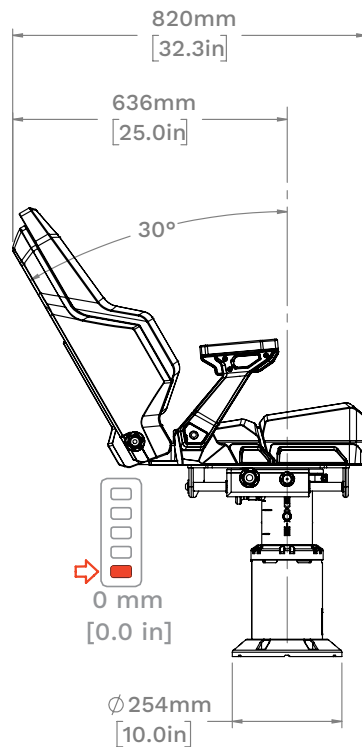
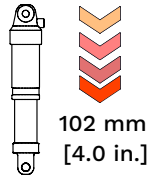

Seat height shown is maximum with fully optioned seat.
Min seat height is 32.75mm lower without options.



X4 ALTERNATIVE MOUNTING RECESSED BELOW DECK

Human Engineering Reference MIL-STD-1472G

Suspension Travel 112 mm / 4.4 in

Material CNC Aluminum

Options n/a

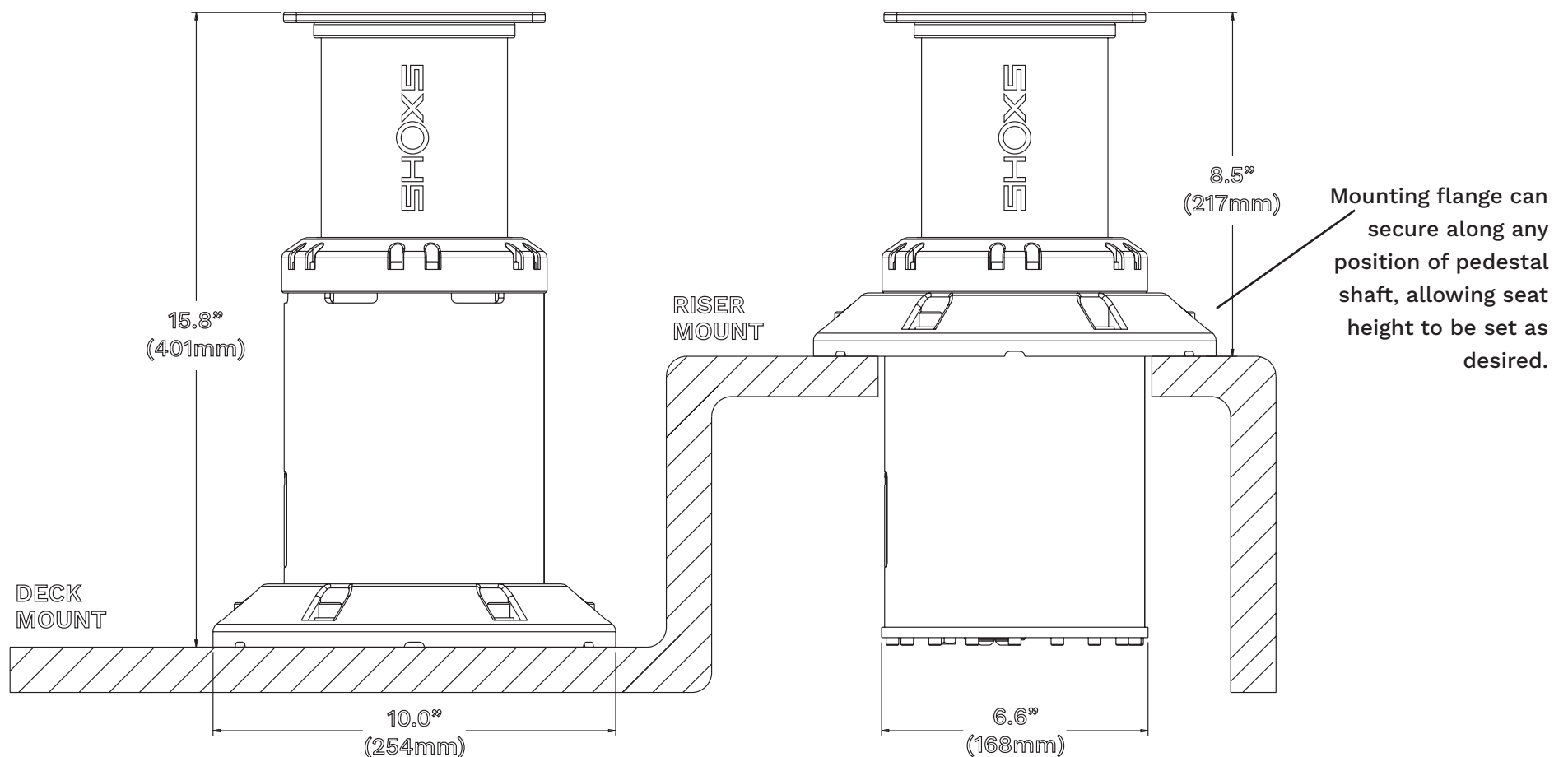

ALLSALT MARITIME HOME OF SHOX5 AND KINETIX / ALLSALT.COM / 1 (888) 637.4697