

**SHOX5**  
**TRAXS INFOSET**

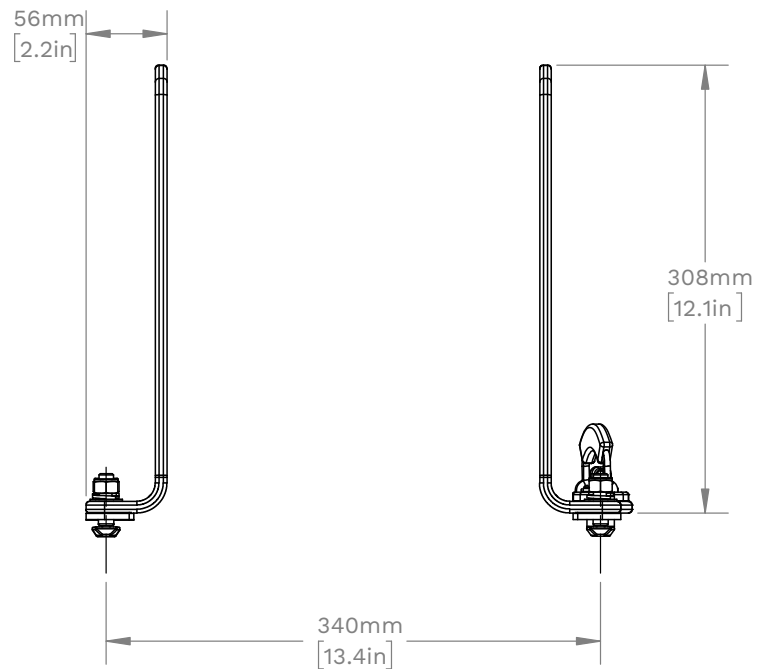

## TRAXS BOLT DOWN DRAWING



SHOXSTRAXS Lateral Spacing: 340mm [13.4"]

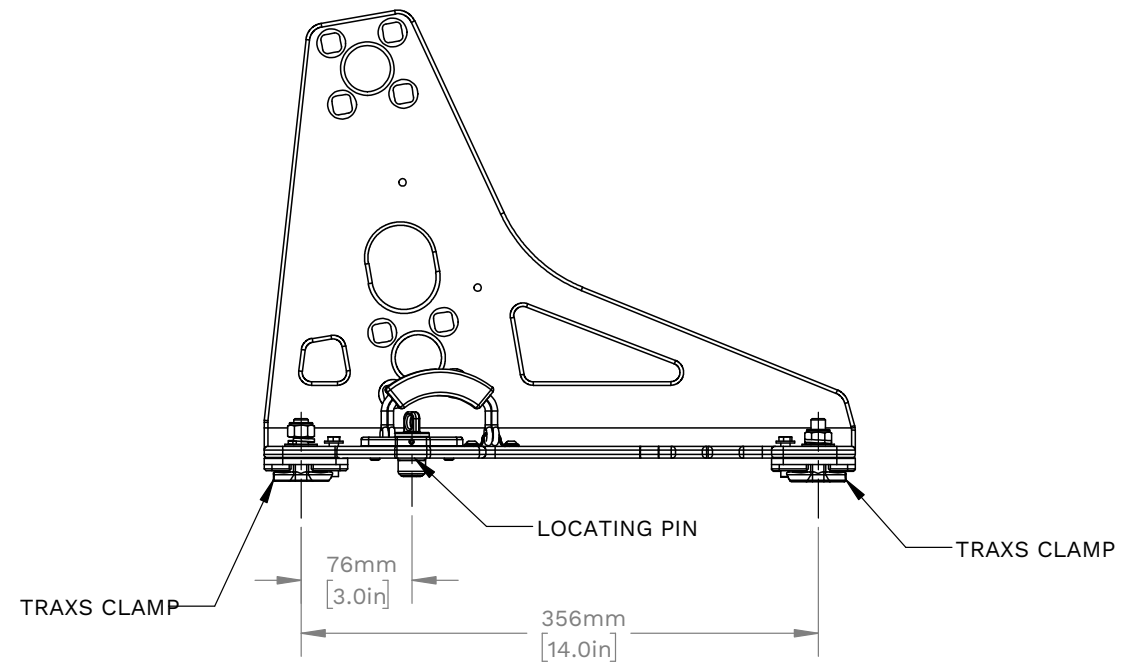

### NOTES:

1. Simple, lightweight, low cost bolt down SHOXSTRAXS hardware.
2. Uses a locating pin on a lanyard to position the seat on the track for installation.
3. Seat can be installed or removed quickly and easily by tightening or loosening 4x 10mm Nylock nuts using a 17mm wrench.



## TRAXS BOLT DOWN - EXPLODED VIEW

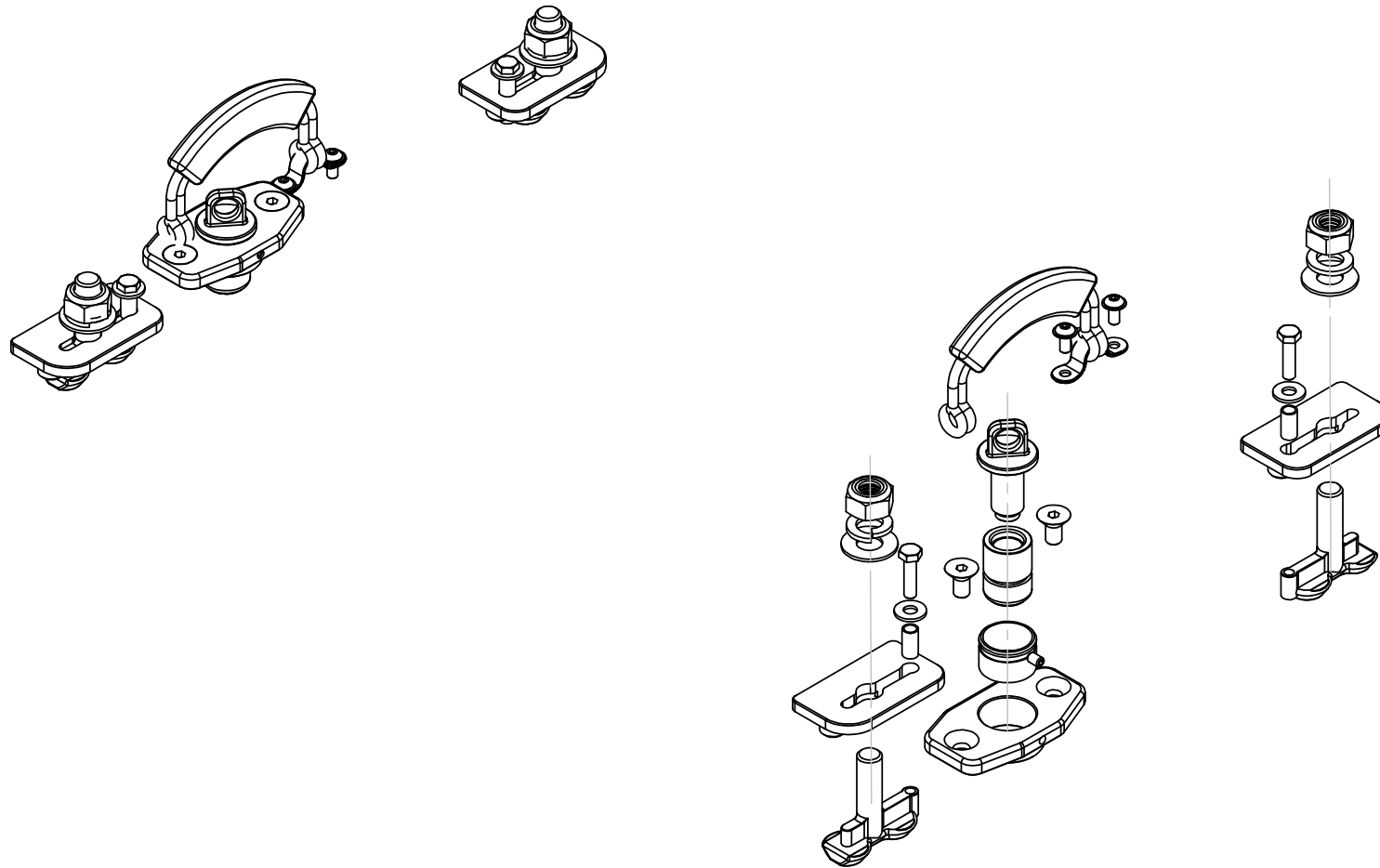

**ALLSALT MARITIME** OWNER OF SHOXS AND KINETIX / [ALLSALT.COM](http://ALLSALT.COM) / [SHOXS.COM](http://SHOXS.COM) / 1 (888) 637.4697



## TRAXS CAM LOCK SIDE PULL

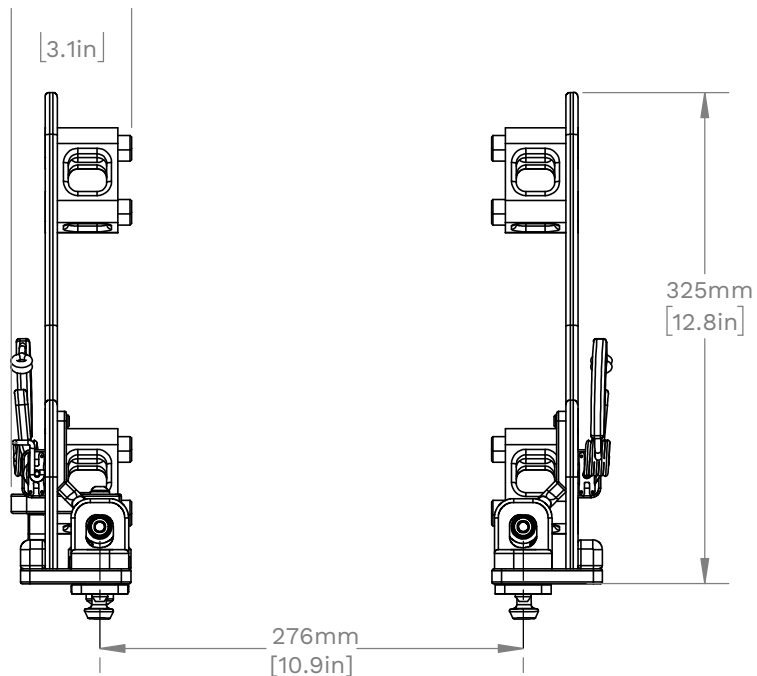

SHOXSTRAXS Lateral Spacing: 276mm [10.9"]

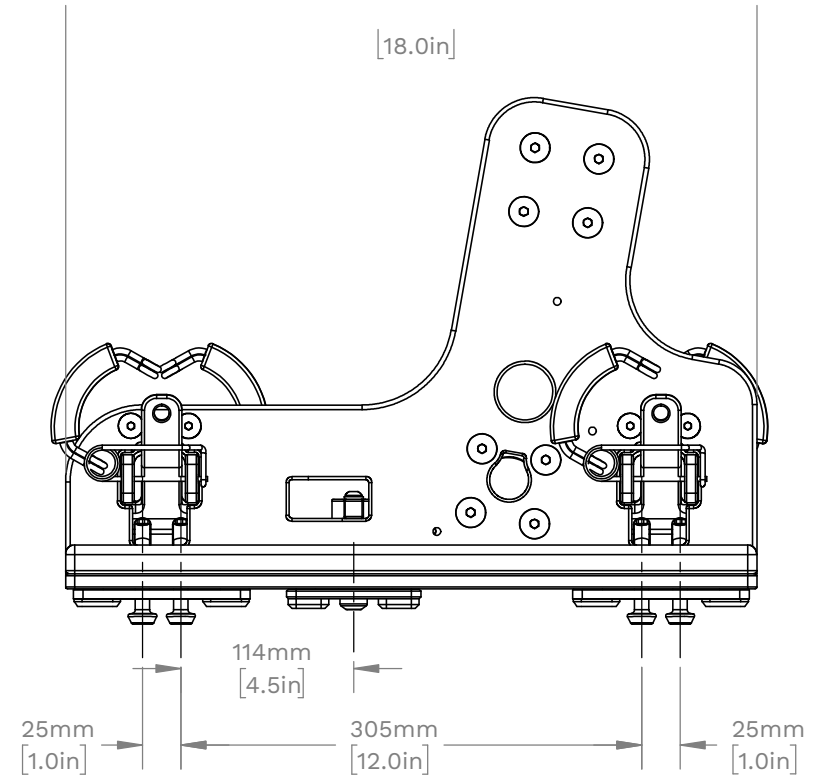

### NOTES:

1. Low profile, quick release SHOXSTRAXS hardware.
2. Uses a spring plunger locating peg to position the seat on the track for installation.
3. Seat can be installed or removed quickly by pushing or pulling 4 release levers inwards/outward and does not require the use of any tools.
4. Cam levers stow flush with the side of the deck bracket to reduce tripping hazards.



## TRAXS CAM LOCK SIDE PULL EXPLODED VIEW

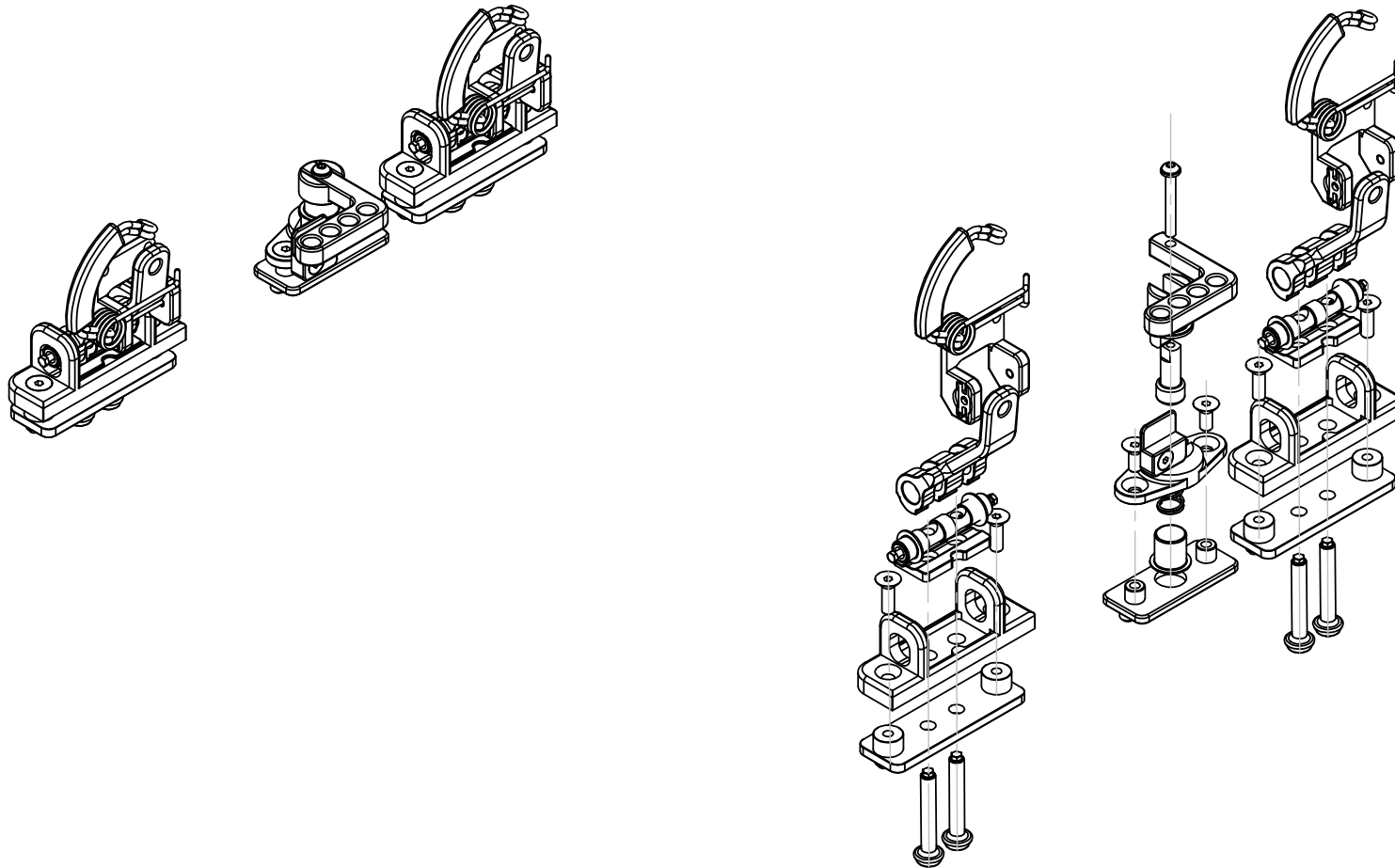



## TRAXS CAM LOCK FOLD OVER LEVER

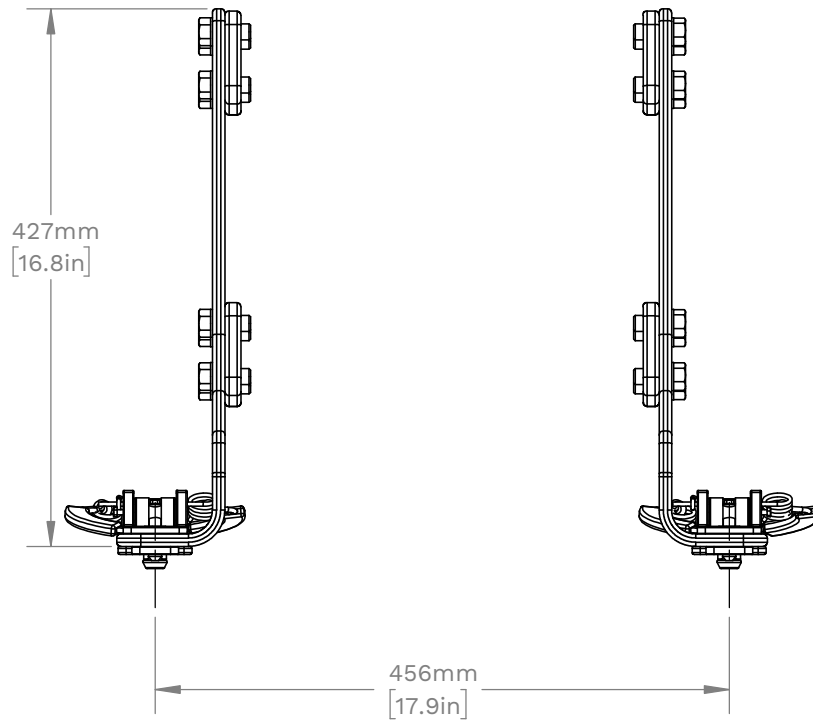

SHOXSTRAXS Lateral Spacing: 455.7mm [17.9"]

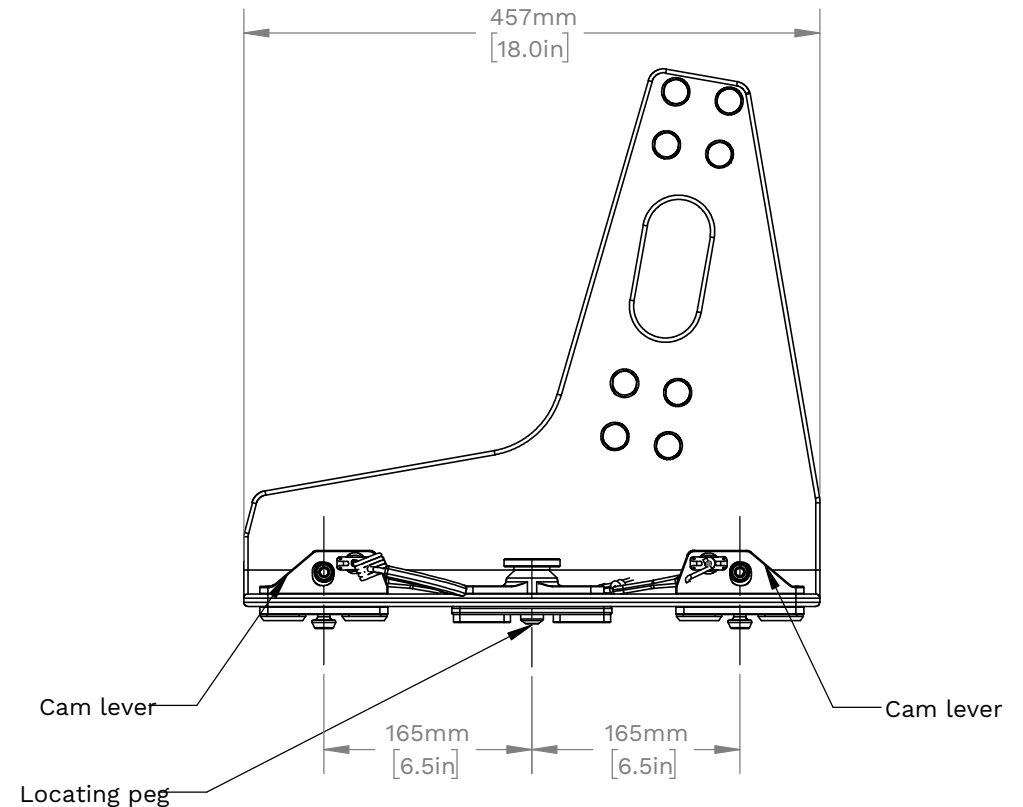

### NOTES:

1. Deck mounted, quickrelease SHOXSTRAXS hardware.
2. Uses a spring plunger locating peg to position the seat on the track for installation.
3. Seat can be installed or removed quickly by pushing or pulling 4 release levers down/up and does not require the use of any tools.

**ALLSALT MARITIME** OWNER OF SHOX5 AND KINETIX / ALLSALT.COM / SHOX5.COM / 1 (888) 637.4697



## TRAXS CAM LOCK FOLD OVER LEVER EXPLODED VIEW

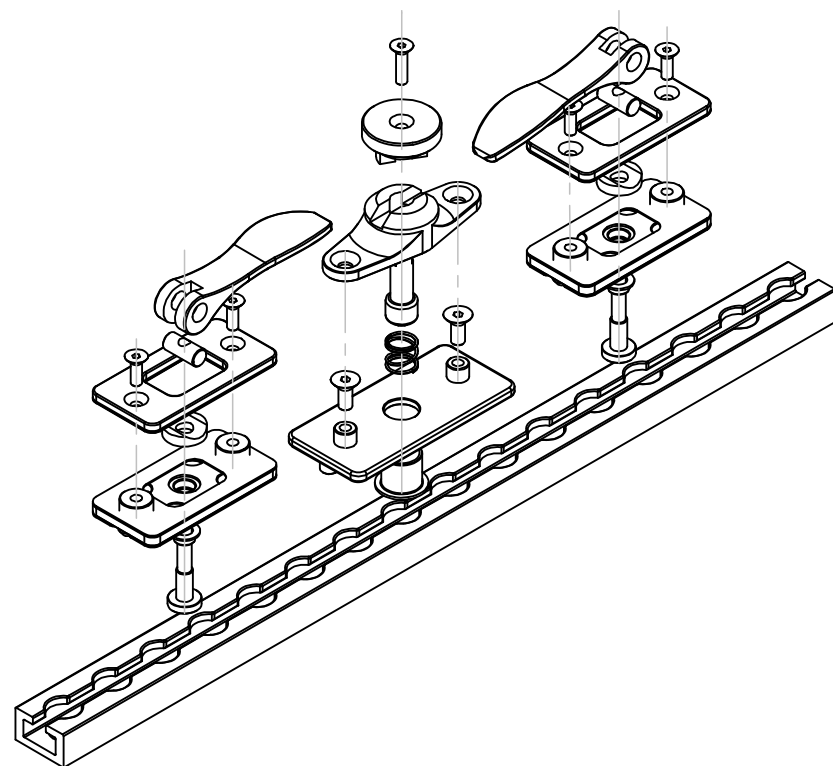
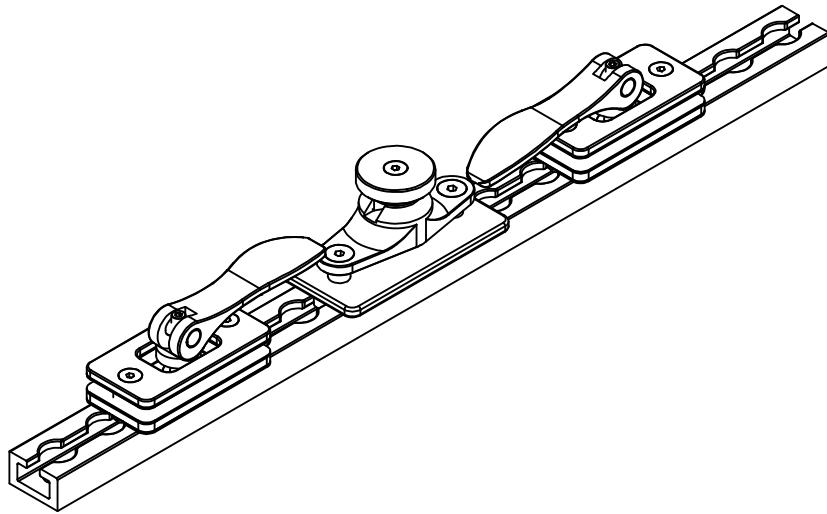

Recommended Fastener Spacing for bolt down track: 152mm [6"]

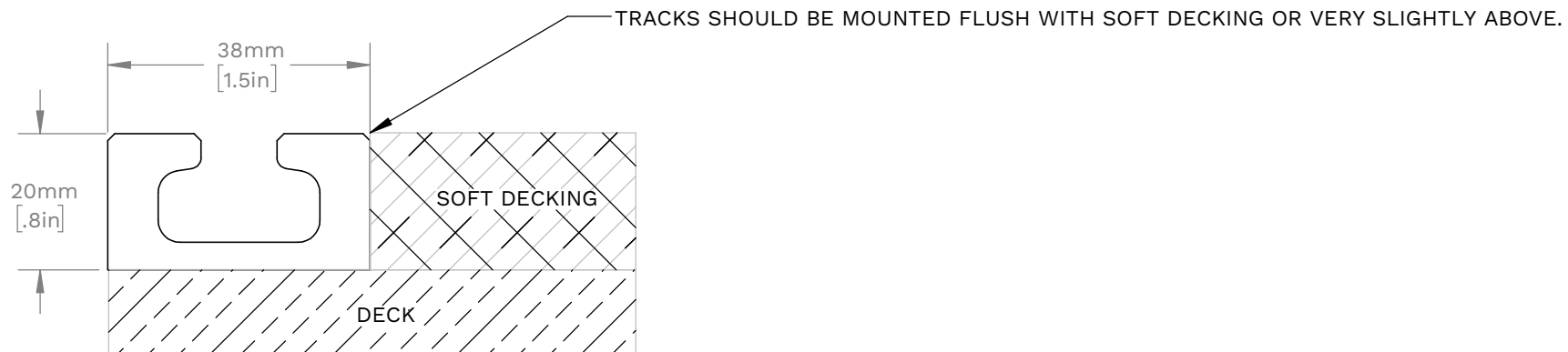
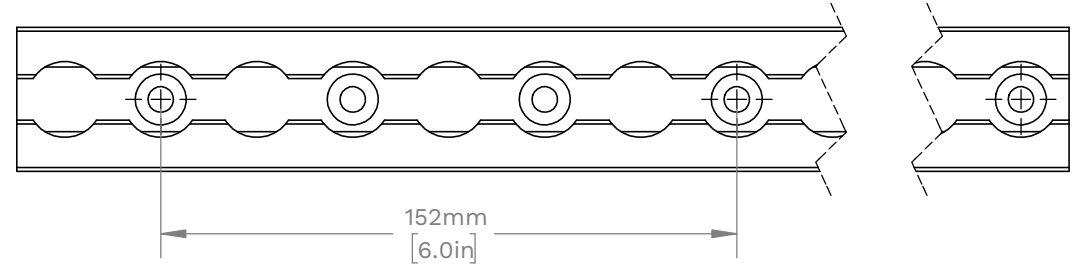

### NOTES:

1. SHOXSTRAXS track allows for the mounting of SHOXSTRAXS hardware equipped seats along with standard logistics track hardware.
2. SHOXSTRAXS track features a deeper groove than standard logistics track to allow for more robust hardware to be installed while reducing the impact of salt and grit buildup.
3. The track can be either bare 6061-T6 aluminum or hard coat anodised.
4. Tracks can be welded in place (bare Al only) or bolted down using M6 or 1/4" countersunk fasteners spaced a minimum of 1" intervals apart (customer must supply the bolting hole pattern required)





## SIDE BY SIDE COMPARISON - TRAXS

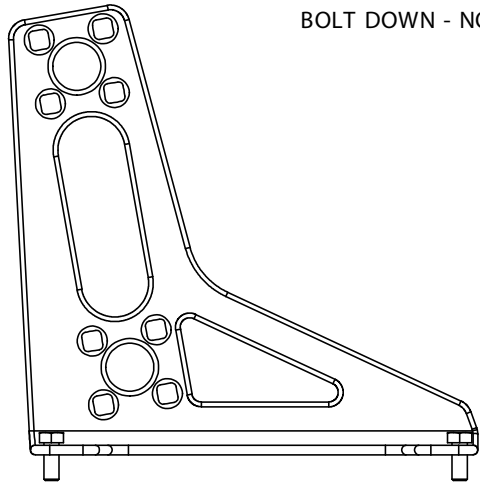

BOLT DOWN - NO TRAXS

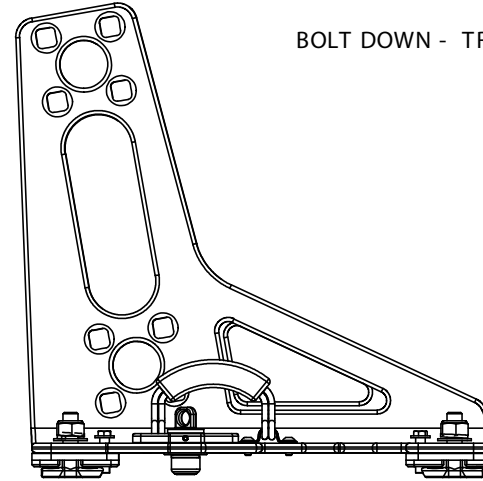

BOLT DOWN - TRAXS

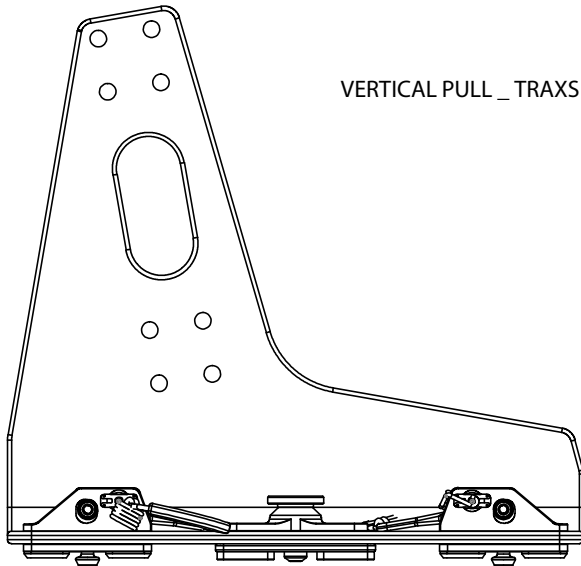

VERTICAL PULL \_ TRAXS

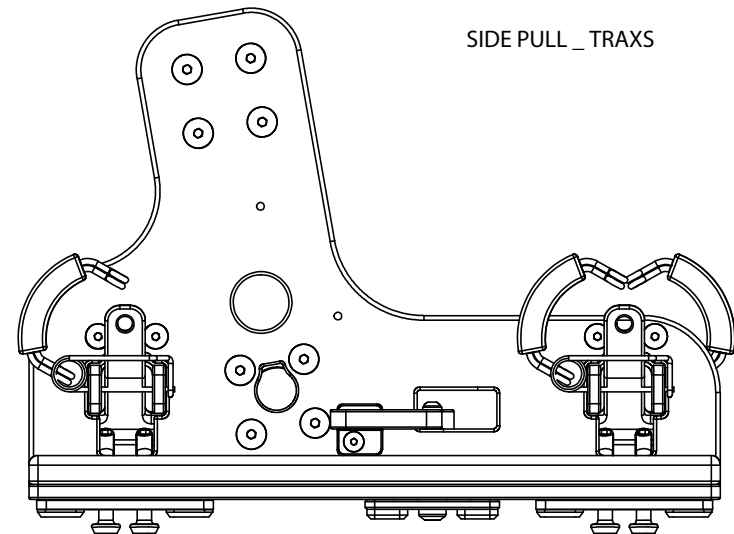

SIDE PULL \_ TRAXS

**ALLSALT MARITIME** OWNER OF SHOX5 AND KINETIX / [ALLSALT.COM](http://ALLSALT.COM) / [SHOX5.COM](http://SHOX5.COM) / 1 (888) 637.4697